



## PUNZON DE CORTE CILINDRICO CABEZA CONICA FORMA "D" DIN 9861 ISO 6752 PUNCH WITH COUNTERSUNK HEAD FORM "D" DIN 9861 ISO 6752

**MATERIAL :** Ac.Carbono WS , 12% Cromo HWS y Ac. Rapido HSS.  
**FABRICACION :** Templado, revenido y rectificado totalmente, excepto Ac.Carbono.  
**VERSION :** Hardened, tempered and fully fine ground finished, excepting WS.  
 Cabeza estampada en caliente.  
 Head hot tempered and annealed.  
 Los punzones en 12% Cromo resisten temperaturas de hasta 520º C.  
 Punches in HWS are heat resistant up to 520 º C.

**DUREZAS :** **D1:** 60-62 HRC.( WS y HWS )  
**HARDNESS :** 62-64 HRC.( HSS )  
 Cabeza: 45±5 HRC.  
 Head:

d1 (h6)	d2 (±0,1)	h (+0,2)	L + 0,5 0
0.3	0.9	0.72	71 - 80 - 100
0.35	0.9	0.68	71 - 80 - 100
0.4	0.9	0.63	71 - 80 - 100
0.45	0.9	0.59	71 - 80 - 100
0.5	0.9	0.55	71 - 80 - 100
0.55	1.0	0.59	71 - 80 - 100
0.6	1.1	0.63	71 - 80 - 100
0.65	1.2	0.68	71 - 80 - 100
0,7	1.3	0.72	71 - 80 - 100
0,75	1.3	0.68	71 - 80 - 100
0,8	1.4	0.92	71 - 80 - 100
0,85	1.4	0.88	71 - 80 - 100
0,9	1.6	1.01	71 - 80 - 100
0,95	1.6	0.96	71 - 80 - 100
1,0	1.8	1.19	71 - 80 - 100
1,05	1.8	1.15	71 - 80 - 100
1,1	1.8	1.11	71 - 80 - 100
1,15	1.8	1.06	71 - 80 - 100
1,20	2.0	1.19	71 - 80 - 100
1,25	2.0	1.15	71 - 80 - 100
1,3	2.0	1.11	71 - 80 - 100
1,35	2.0	1.06	71 - 80 - 100
1,4	2.2	1.19	71 - 80 - 100
1,45	2.2	1.15	71 - 80 - 100
1,5	2.2	1.11	71 - 80 - 100
1,55	2.2	1.06	71 - 80 - 100
1,6	2.5	1.28	71 - 80 - 100
1,65	2.5	1.24	71 - 80 - 100
1,7	2.5	1.19	71 - 80 - 100
1,75	2.5	1.15	71 - 80 - 100
1,8	2.8	1.37	71 - 80 - 100
1,85	2.8	1.32	71 - 80 - 100
1,9	2.8	1.28	71 - 80 - 100
1,95	2.8	1.24	71 - 80 - 100
2,0	3.0	1.37	71 - 80 - 100
2,05	3.0	1.32	71 - 80 - 100
2,10	3.2	1.45	71 - 80 - 100
2,15	3.2	1.41	71 - 80 - 100
2,2	3.2	1.37	71 - 80 - 100
2,25	3.2	1.32	71 - 80 - 100
2,3	3.5	1.54	71 - 80 - 100
2,35	3.5	1.50	71 - 80 - 100

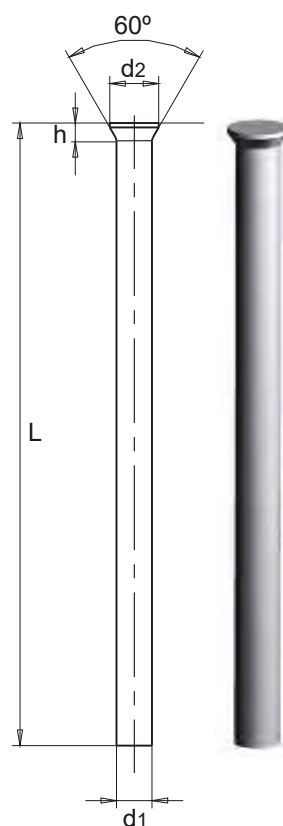

**FORMA DE PEDIDO: ORDER FORM: Material,d1 x L.**  
**L=130 DISPONIBLE SOLO EN ACERO RÁPIDO L=130 AVAILABLE ONLY IN HSS**



**PUNZON DE CORTE CILINDRICO CABEZA CONICA FORMA "D" DIN 9861 ISO 6752  
(CONTINUACION)**

**PUNCH WITH COUNTERSUNK HEAD FORM "D" DIN 9861 ISO 6752 (CONT.)**

d1 (h6)	d2 (±0,1)	h (+0,2)	L + 0,5
2.4	3.5	1.45	71 - 80 - 100
2.45	3.5	1.41	71 - 80 - 100
2.5	3.5	1.37	71 - 80 - 100
2.55	3.5	1.32	71 - 80 - 100
2.6	4.0	1.71	71 - 80 - 100
2.65	4.0	1.67	71 - 80 - 100
2.7	4.0	1.63	71 - 80 - 100
2.75	4.0	1.58	71 - 80 - 100
2.8	4.0	1.54	71 - 80 - 100
2.85	4.0	1.50	71 - 80 - 100
2.9	4.0	1.45	71 - 80 - 100
2.95	4.0	1.41	71 - 80 - 100
3.0	4,5	1.80	71 - 80 - 100
3.05	4.5	1.76	71 - 80 - 100
3.10	4.5	1.71	71 - 80 - 100
3.15	4.5	1.67	71 - 80 - 100
3.2	4.5	1.63	71 - 80 - 100
3.25	4.5	1.58	71 - 80 - 100
3.3	4.5	1.54	71 - 80 - 100
3.35	4.5	1.50	71 - 80 - 100
3.4	4.5	1.45	71 - 80 - 100
3.45	4.5	1.41	71 - 80 - 100
3.5	5.0	1.80	71 - 80 - 100
3.55	5.0	1.76	71 - 80 - 100
3.6	5.0	1.71	71 - 80 - 100
3.65	5.0	1.67	71 - 80 - 100
3.7	5.0	1.63	71 - 80 - 100
3.75	5.0	1.58	71 - 80 - 100
3.8	5.0	1.54	71 - 80 - 100
3.85	5.0	1.50	71 - 80 - 100
3.9	5.0	1.45	71 - 80 - 100
3.95	5.0	1.41	71 - 80 - 100
4.0	5.5	1.80	71 - 80 - 100 - 130
4.05	5.5	1.76	71 - 80 - 100
4.10	5.5	1.71	71 - 80 - 100
4.15	5.5	1.67	71 - 80 - 100
4.2	5.5	1.63	71 - 80 - 100
4.25	5.5	1.58	71 - 80 - 100
4.3	5.5	1.54	71 - 80 - 100
4.35	5.5	1.50	71 - 80 - 100
4.4	5.5	1.45	71 - 80 - 100
4.45	5.5	1.41	71 - 80 - 100
4.5	6.0	1.80	71 - 80 - 100
4.55	6.0	1.76	71 - 80 - 100
4.6	6.0	1.71	71 - 80 - 100
4.65	6.0	1.67	71 - 80 - 100
4.7	6.0	1.63	71 - 80 - 100
4.75	6.0	1.58	71 - 80 - 100
4.8	6.0	1.54	71 - 80 - 100
4.85	6.0	1.50	71 - 80 - 100
4.9	6.0	1.45	71 - 80 - 100
4.95	6.0	1.41	71 - 80 - 100
5.0	6.5	1.80	71 - 80 - 100 - 130

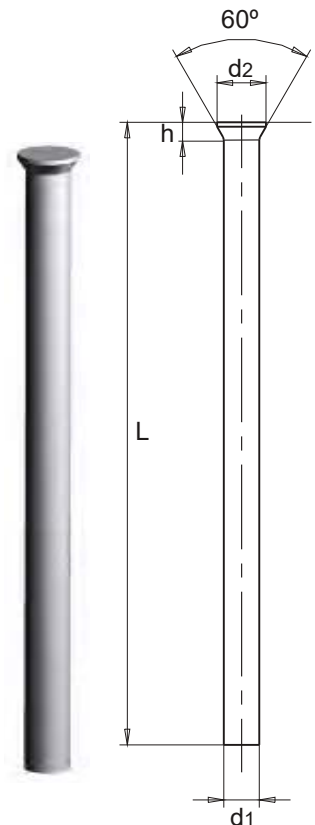

**FORMA DE PEDIDO: ORDER FORM: Material,d1 x L.  
L=130 DISPONIBLE SOLO EN ACERO RÁPIDO L=130 AVAILABLE ONLY IN HSS**



**PUNZON DE CORTE CILINDRICO CABEZA CONICA FORMA "D" DIN 9861 ISO 6752  
(CONTINUACION)**

**PUNCH WITH COUNTERSUNK HEAD FORM "D" DIN 9861 ISO 6752 (CONT.)**

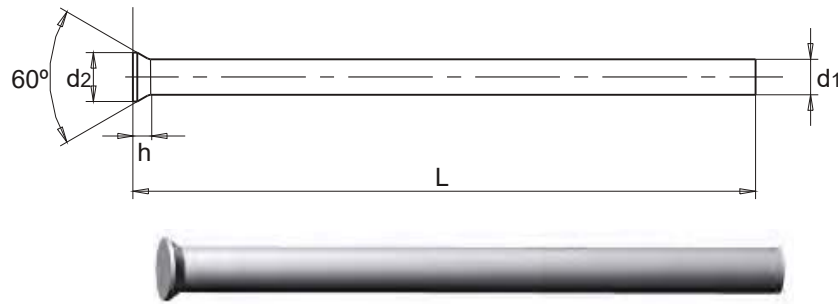

d1 (h6)	d2 ( $\pm 0,1$ )	h (+0,2)	L $+ \frac{0,5}{0}$
5.05	6.5	1.76	71 - 80 - 100
5.1	6.5	1.71	71 - 80 - 100
5.15	6.5	1.67	71 - 80 - 100
5.2	6.5	1.63	71 - 80 - 100
5.3	6.5	1.54	71 - 80 - 100
5.4	6.5	1.45	71 - 80 - 100
5.45	6.5	1.41	71 - 80 - 100
5.5	7.0	1.80	71 - 80 - 100
5.6	7.0	1.71	71 - 80 - 100
5.7	7.0	1.63	71 - 80 - 100
5.75	7.0	1.58	71 - 80 - 100
5.8	7.0	1.54	71 - 80 - 100
5.9	7.0	1.45	71 - 80 - 100
6.0	8.0	2.23	71 - 80 - 100 - 130
6.05	8.0	2.19	71 - 80 - 100
6.1	8.0	2.15	71 - 80 - 100
6.2	8.0	2.06	71 - 80 - 100
6.3	8.0	1.97	71 - 80 - 100
6.4	8.0	1.89	71 - 80 - 100
6.5	9.0	3.17	71 - 80 - 100
6.6	9.0	3.08	71 - 80 - 100
6.7	9.0	2.99	71 - 80 - 100
6.8	9.0	2.91	71 - 80 - 100
6.9	9.0	2.82	71 - 80 - 100
7.0	9.0	2.73	71 - 80 - 100 - 130
7.1	9.0	2.65	71 - 80 - 100
7.2	9.0	2.56	71 - 80 - 100
7.25	9.0	2.52	71 - 80 - 100
7.3	9.0	2.47	71 - 80 - 100
7.4	9.0	2.39	71 - 80 - 100
7.5	10.0	3.17	71 - 80 - 100
7.6	10.0	3.08	71 - 80 - 100
7.7	10.0	2.99	71 - 80 - 100
7.8	10.0	2.91	71 - 80 - 100
7.9	10.0	2.82	71 - 80 - 100
8.0	10.0	2.73	71 - 80 - 100 - 130
8.1	10.0	2.65	71 - 80 - 100
8.2	10.0	2.56	71 - 80 - 100
8.3	10.0	2.47	71 - 80 - 100
8.4	10.0	2.39	71 - 80 - 100

**FORMA DE PEDIDO: ORDER FORM: Material, d1 x L.  
L=130 DISPONIBLE SOLO EN ACERO RÁPIDO L=130 AVAILABLE ONLY IN HSS**



**PUNZON DE CORTE CILINDRICO CABEZA CONICA FORMA "D" DIN 9861 ISO 6752 (CONTINUACION)**  
**PUNCH WITH COUNTERSUNK HEAD FORM "D" DIN 9861 ISO 6752 (CONT.)**

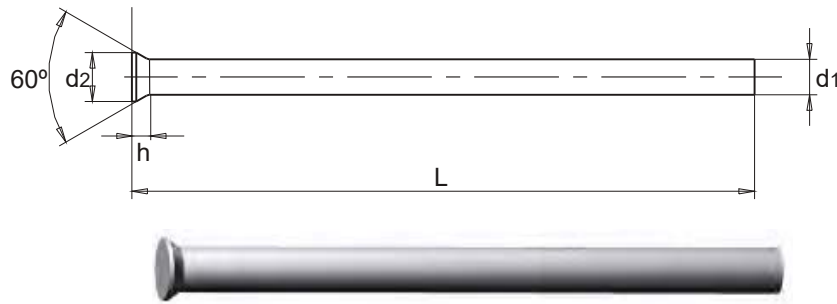

d1 (h6)	d2 (+0,1)	h (+0,2)	L + 0,5
8.5	11.0	3.17	71 - 80 - 100
8.6	11.0	3.08	71 - 80 - 100
8.7	11.0	2.99	71 - 80 - 100
8.8	11.0	2.91	71 - 80 - 100
8.9	11.0	2.82	71 - 80 - 100
9.0	11.0	2.73	71 - 80 - 100 - 130
9.05	11.0	2.69	71 - 80 - 100
9.1	11.0	2.65	71 - 80 - 100
9.2	11.0	2.56	71 - 80 - 100
9.3	11.0	2.47	71 - 80 - 100
9.4	11.0	2.39	71 - 80 - 100
9.5	12.0	3.17	71 - 80 - 100
9.6	12.0	3.08	71 - 80 - 100
9.7	12.0	2.99	71 - 80 - 100
9.8	12.0	2.91	71 - 80 - 100
9.9	12.0	2.82	71 - 80 - 100
10.0	12.0	2.73	71 - 80 - 100 - 130
10.1	12.0	2.65	71 - 80 - 100
10.2	12.0	2.56	71 - 80 - 100
10.3	12.0	2.47	71 - 80 - 100
10.4	12.0	2.39	71 - 80 - 100
10.5	13.0	3.17	71 - 80 - 100
10.6	13.0	3.08	71 - 80 - 100
10.7	13.0	2.99	71 - 80 - 100
10.8	13.0	2.91	71 - 80 - 100
10.9	13.0	2.82	71 - 80 - 100
11.0	13.0	2.73	71 - 80 - 100 - 130
11.1	13.0	2.65	71 - 80 - 100
11.2	13.0	2.56	71 - 80 - 100
11.3	13.0	2.47	71 - 80 - 100
11.4	13.0	2.39	71 - 80 - 100
11.5	14.0	3.17	71 - 80 - 100
11.6	14.0	3.08	71 - 80 - 100
11.7	14.0	2.99	71 - 80 - 100
11.8	14.0	2.91	71 - 80 - 100

**FORMA DE PEDIDO: ORDER FORM: Material, d1 x L.**  
**L=130 DISPONIBLE SOLO EN ACERO RÁPIDO L=130 AVAILABLE ONLY IN HSS**



**PUNZON DE CORTE CILINDRICO CABEZA CONICA FORMA "D" DIN 9861 ISO 6752  
(CONTINUACION)  
PUNCH WITH COUNTERSUNK HEAD FORM "D" DIN 9861 ISO 6752 (CONT.)**

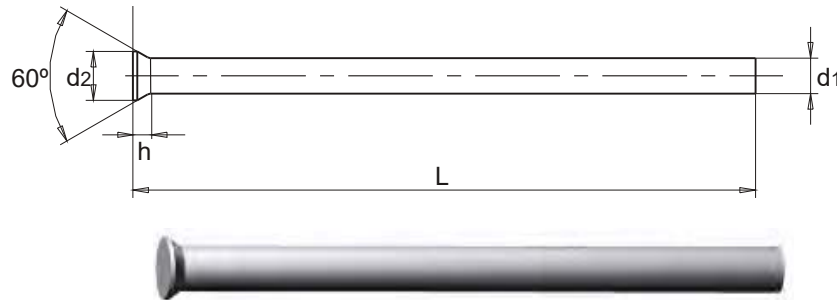

d1 (h6)	d2 ( $\pm 0,1$ )	h (+0,2)	L + $\frac{0,5}{0}$
11.9	14.0	2.82	71 - 80 - 100
12.0	14.0	2.73	71 - 80 - 100 - 130
12.1	14.0	2.65	71 - 80 - 100
12.2	14.0	2.56	71 - 80 - 100
12.3	14.0	2.47	71 - 80 - 100
12.4	14.0	2.39	71 - 80 - 100
12.5	15.0	3.17	71 - 80 - 100
12.6	15.0	3.08	71 - 80 - 100
12.7	15.0	2.99	71 - 80 - 100
12.8	15.0	2.91	71 - 80 - 100
12.9	15.0	2.82	71 - 80 - 100
13.0	15.0	2.73	71 - 80 - 100
13.5	16.0	3.67	71 - 80 - 100
14.0	16.0	3.23	71 - 80 - 100
14.5	17.0	3.67	71 - 80 - 100
15.0	17.0	3.23	71 - 80 - 100
15.5	18.0	3.67	71 - 80 - 100
16.0	18.0	3.23	71 - 80 - 100
16.5	19.0	3.67	71 - 80 - 100
17.0	19.0	3.23	71 - 80 - 100
17.5	20.0	3.67	71 - 80 - 100
18.0	20.0	3.23	71 - 80 - 100
18.5	21.0	3.67	71 - 80 - 100
19.0	21.0	3.23	71 - 80 - 100
19.5	22.0	3.67	71 - 80 - 100
20.0	22.0	3.23	71 - 80 - 100

**FORMA DE PEDIDO: ORDER FORM: Material, d1 x L.  
L=130 DISPONIBLE SOLO EN ACERO RÁPIDO L=130 AVAILABLE ONLY IN HSS  
TAMBIEN DISPONIBLES TODOS LOS DIAMETROS ,25 Y ,75 mm.  
ALSO AVAILABLE ALL DIAMETERS ,25 AND ,75 mm.**